



Campus Hub Residence University of Malta

STANDARD

Description of Local Area

Campus Hub Residence is centrally located in L-Imsida, right near the University of Malta, which conveniently provides easy transportation to and from all locations around Malta. Restaurants, fast food, and everyday shops can be found within walking distance at every corner. This area provides a real feel of student community life.

Description of Accommodation

These newly built premises are designed and styled perfectly for a student's lifestyle. Several different room options to choose from, suiting any need. All communal areas are fully loaded with Smart TV's and comfortable lounge furniture. A fully equipped kitchen with ample cooking space, dining area, and breakfast zone. Onsite laundry and gym facilities, and a 5-minute bus ride to Malta's National Pool complex - the Campus Hub Residency is a great choice for any student.

Miscellaneous

- Cleaning Service is provided free of charge once a week. Tidying up and refreshing rooms, bathrooms and common areas. Towels and linen also changed weekly. For daily upkeep of the apartment, students must buy their own cleaning material
- Launderettes on site. Ask reception for direction and fees.
- Luggage drop-off is not allowed
- Kitchen utensils are provided free of charge (Cutlery, crockery, pots and pans). No deposit needed
- All Utility Bills and use of A/C included
- Bed linen, one (1) bath towel and one (1) bathmat are provided. However, students should bring their own beach towels
- Hairdryer provided at school's reception against a refundable supplement

Accommodation Features

Room facilities



SAFETY BOX



TV



PHONE



HEATING



AIR CONDITIONING



FAN



BED LINEN

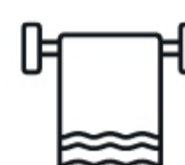

TOWELS



IRON



HAIRDRYER



FREE

WIFI



ROOM CLEANING

Building facilities

- Cleaning Service Provided
- Communal Dining Room
- Communal Kitchen
- Laundry Facilities

Room Type	Single bedroom Twin bedroom Rooms sizes vary
Bathroom Type	Shared / Private (shower/bath) Shared bathroom ratio: up to 6 students max Private bathroom available at an extra supplement
Board Status	Self-catering

Gallery

Images are for representation purpose only. Actual furnishings may differ from those shown. Amenities and services are subject to change. Please refer to partners.ecenglish.com for the most up to date factsheet. Information live on this site will supersede any information provided earlier

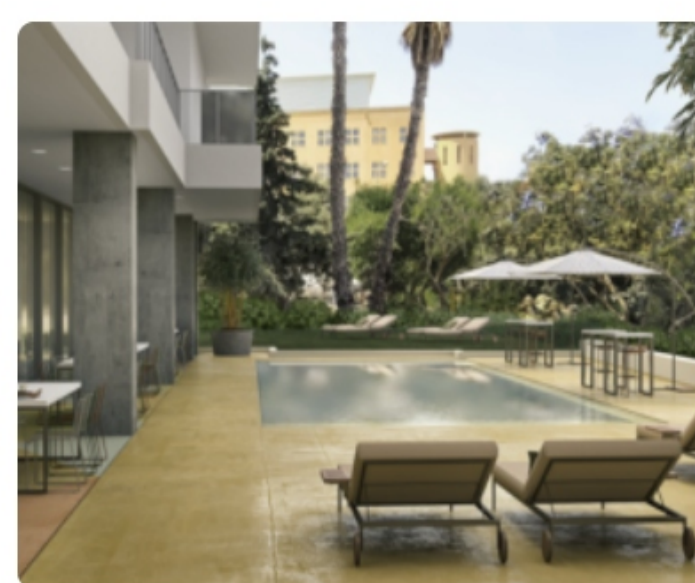
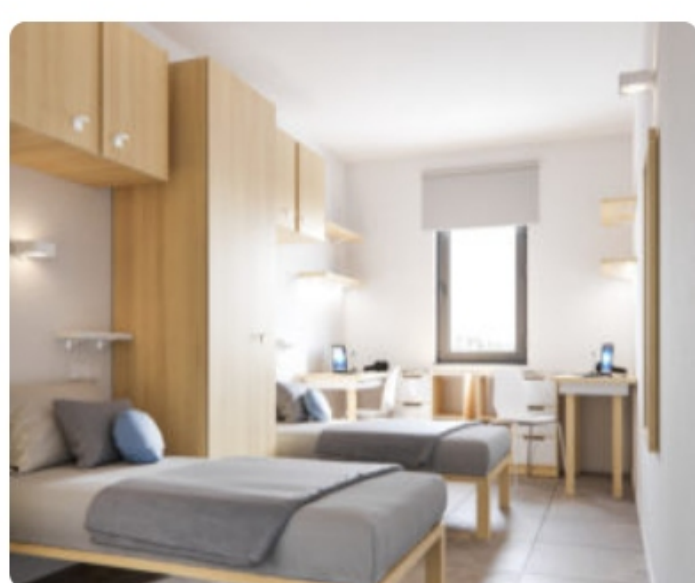

Address

The Campus Hub
Residence.
University of Malta,
Msida. MSD 2080

Phone Number

SCHOOL NUMBER +356
2379 0555 during office
hours (9am to 5pm)

Emergency Number

+356 9946 7078 – 24/7

Journey to school

On foot approximate 45
minutes. By bus
approximate 30 minutes.

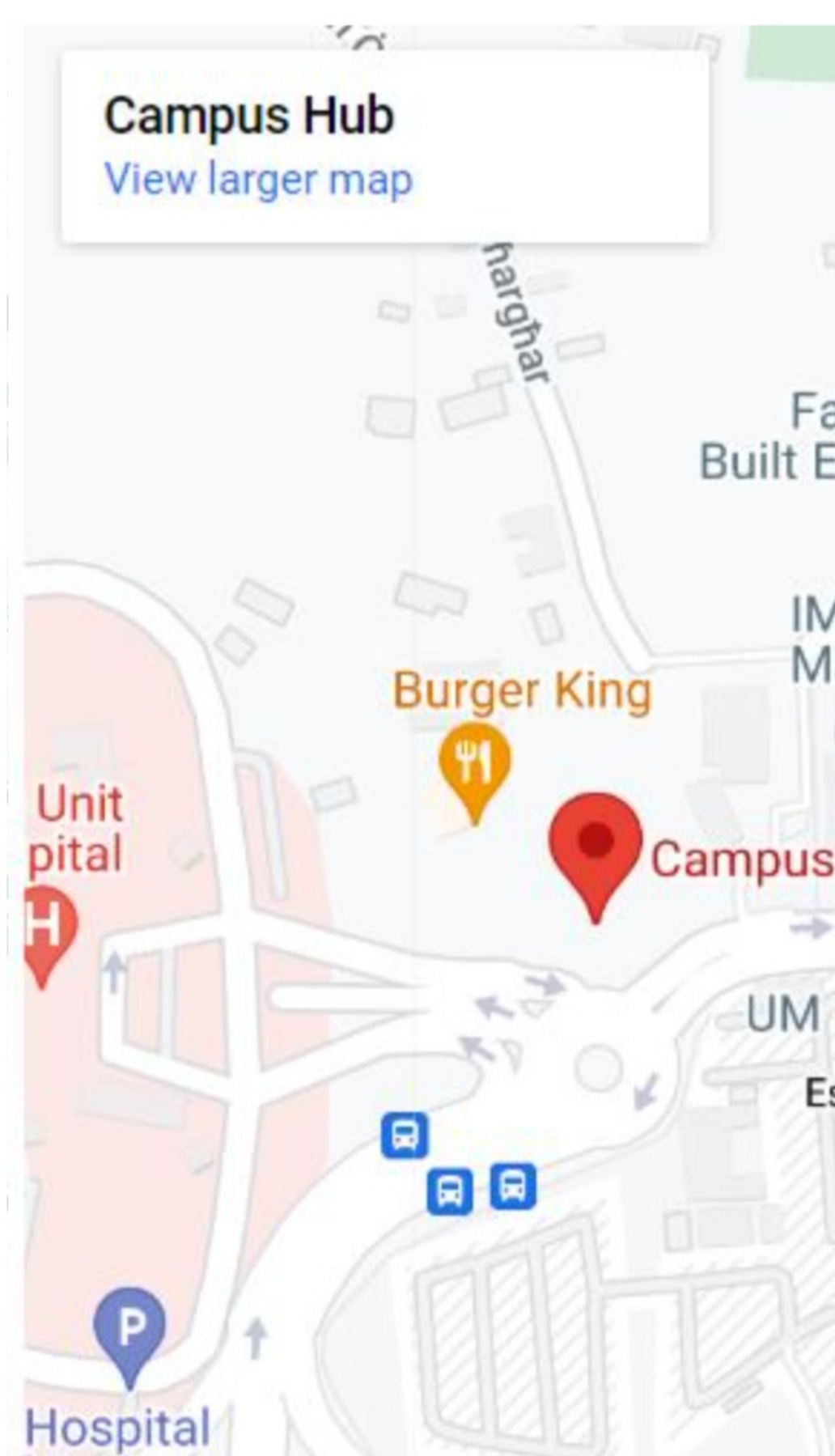

Arrival and departure

Arrival day: Saturday/Sunday (please see **Arrival procedure**)

Check-in: from 14:00

Early check-in is not allowed

Late check-in is allowed (please see **Arrival procedure**)

Departure day: Saturday/Sunday

Check out: 10 am

Late check-out is not allowed.

You are permitted to leave your luggage in the common area of the apartment until you are leaving to go to the airport.

Please remember to leave your apartment and bedroom key as indicated, otherwise, lost key charges may apply.

Cancellations

Cancellation T&C's

- For Cancellation made within 8-13days before check-in date, a 50% cancellation fee will apply capped at 4 weeks.
- For cancellations made one to seven days before check-in date, full cancellation fee capped at 4 weeks will apply'.
- From the day of arrival onwards, full stay charge will apply

Other ways to get to your residence

If, despite free airport transfer offered by EC, you decide to arrange your own transfer, please note that you must contact the school during office hours (Monday to Thursday before the arrival date from 9am to 4pm) to arrange key collection from school reception.

Airport Pickup

Arrival transfer is included free of charge when booking course and accommodation with EC.

Arrival Procedures

Upon arrival and luggage pick-up you will enter the Malta Airport Arrival area, where you should look for your taxi driver who will be holding a white paper with a big orange EC logo. The driver will ask you for your name and surname. The drivers will always try to be on time, however, if for reasons beyond their control, a delay occur, please, call the EC Emergency number on +356 99467078 if more than 10 mins have passed. Please note that our cars have space for 1 cabin luggage and 1 large suitcase per person. You will then be taken to your accommodation. If you arrive before 2pm you can leave your luggage in the common area of the apartment and wait until your bedroom is cleaned before you check-in.

Departure procedure

Check-out from the apartment is 10am. You are permitted to leave your luggage in the common area of the apartment until you are leaving to go to the airport. Please remember to leave your apartment and bedroom key as indicated, otherwise lost key charges may apply.

House Rules

- Students need to be 18+ to choose this accommodation
- All apartments are mixed gender apartments (single gender in twin rooms)
- Every resident has to sign a Shared Apartment Agreement before they can receive the key of the apartment or as otherwise instructed. The Agreement informs the residents that they are responsible for any damages, no guests, no smoking inside the apartments etc. The document is available on request before confirmation of booking.
- Guests are not permitted
- Smoking is not permitted in any part of the apartment
- Garbage and recycling collection times must be followed, or local council fines apply. This info is displayed in each apartment
- While we promote and support diversity, we cannot guarantee language mix. However, we always encourage students to use English to communicate, be respectful and inclusive of others
- EC provides a clean living space for all students and expects a basic level of respect from all students. For example, if something is dropped, pick it up; do not leave clothes and belongings on the floor; place rubbish and leftovers in a garbage bag
- A refundable deposit required upon check – in to cover any potential damages. In case of a month booking- 100 euro, 2 months booking – 200 euro or 350 euro in case of a booking for 3 or more months
- Students are required to follow **EC Student Code of Conduct**, failure to do so can result in termination of the accommodation.

For more accommodation terms please refer to **EC accommodation terms**.